

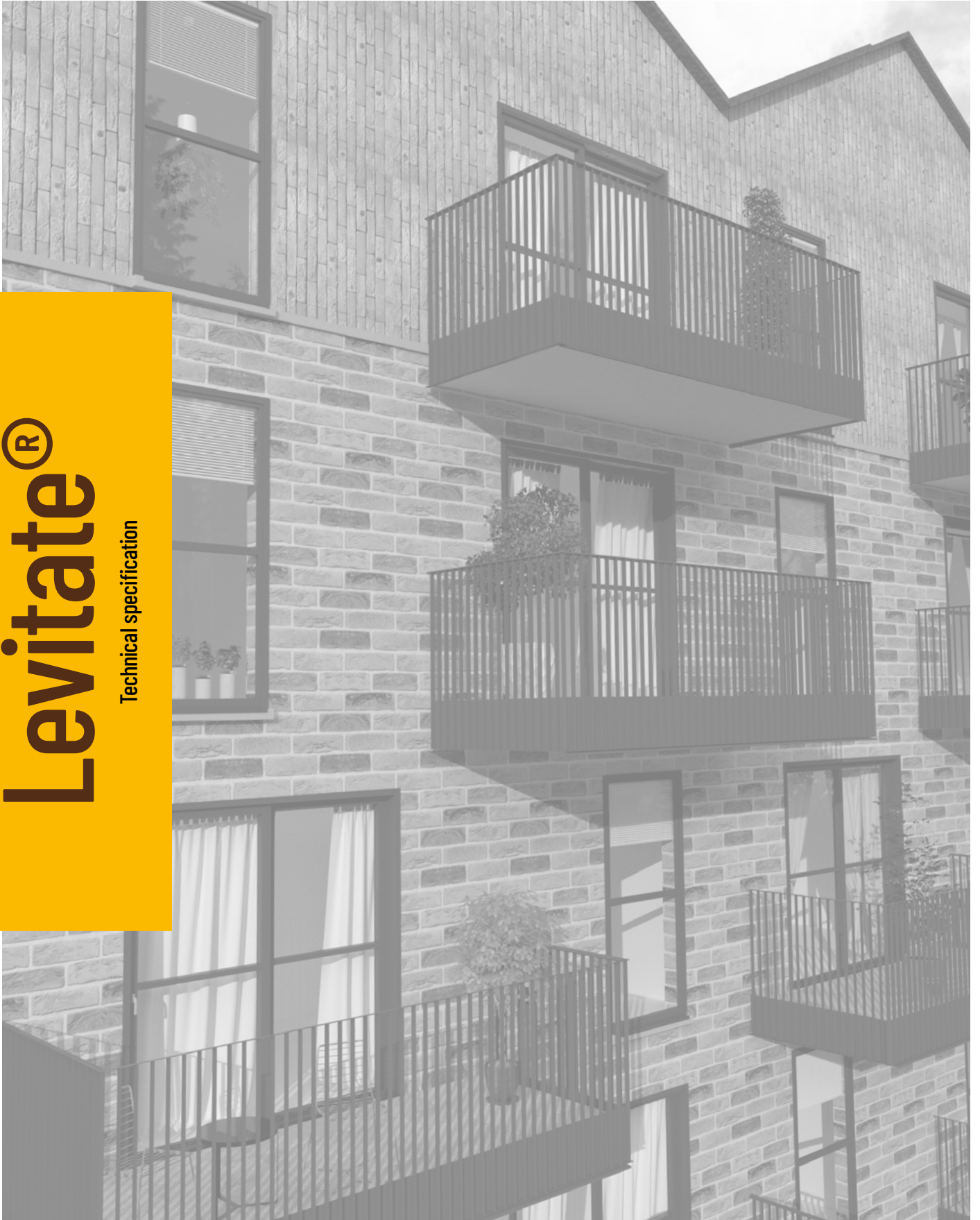

BALCONIES
FOR
GREATER
LIVING

Levitate[®]

Technical specification



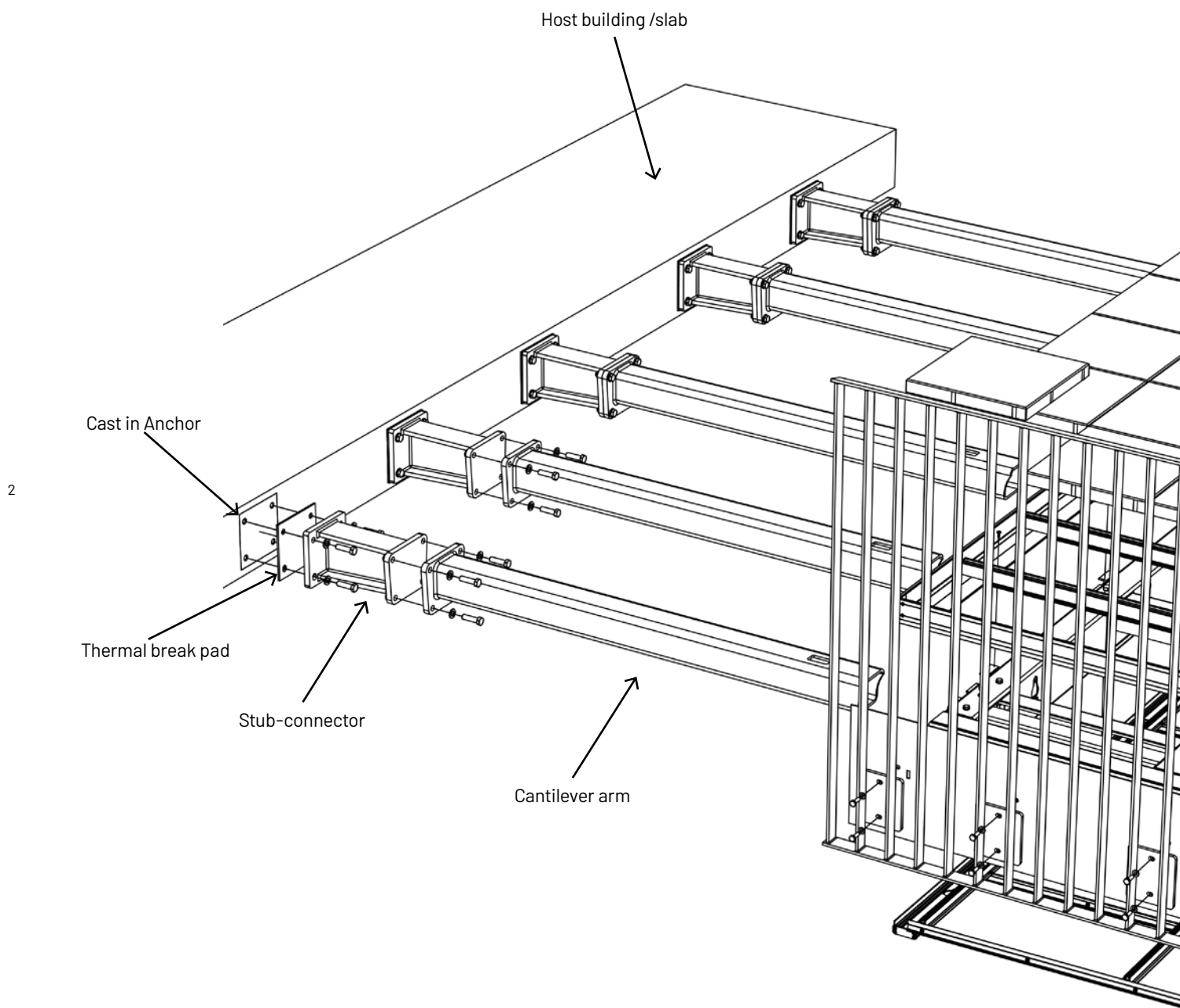

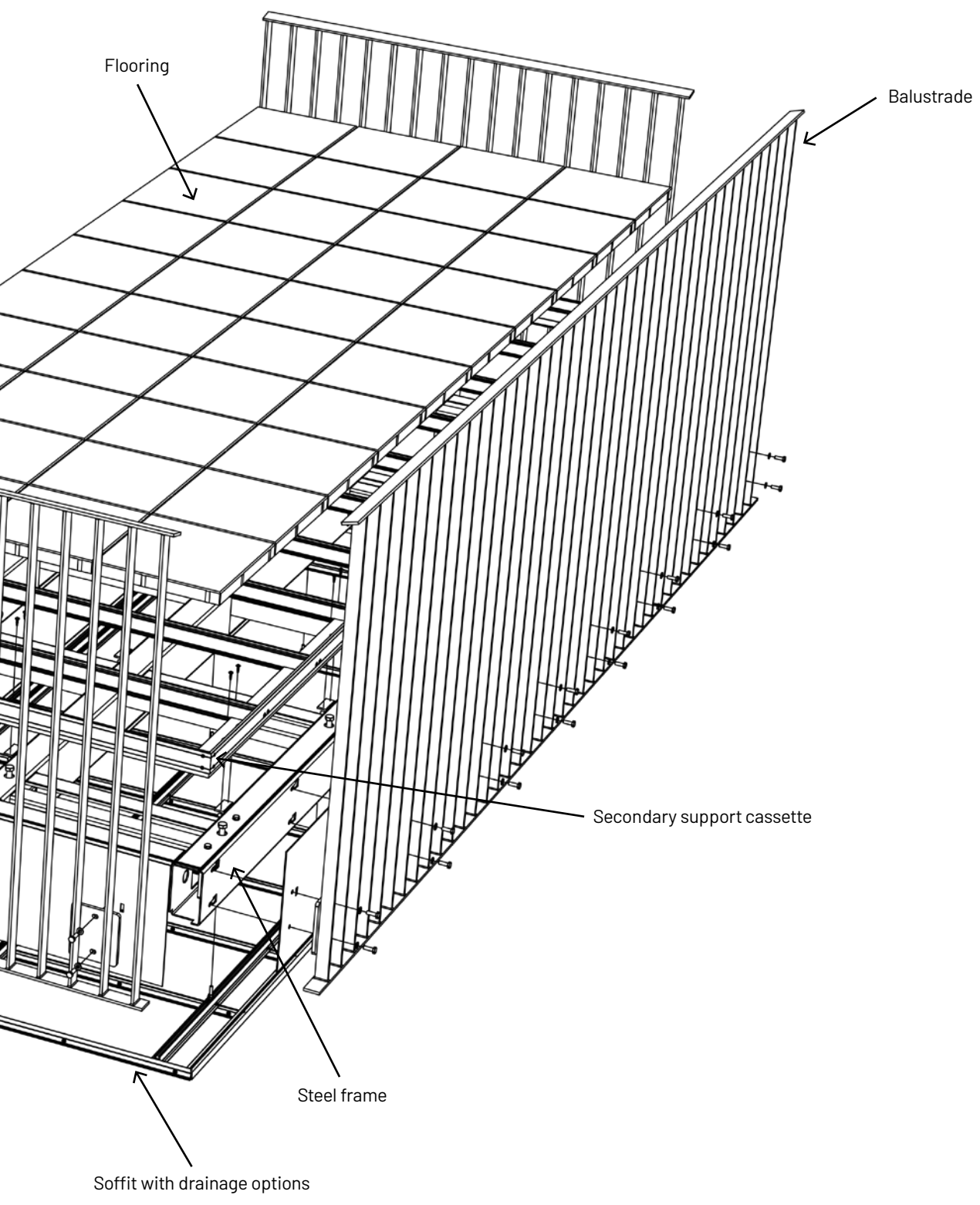

Stub-connector

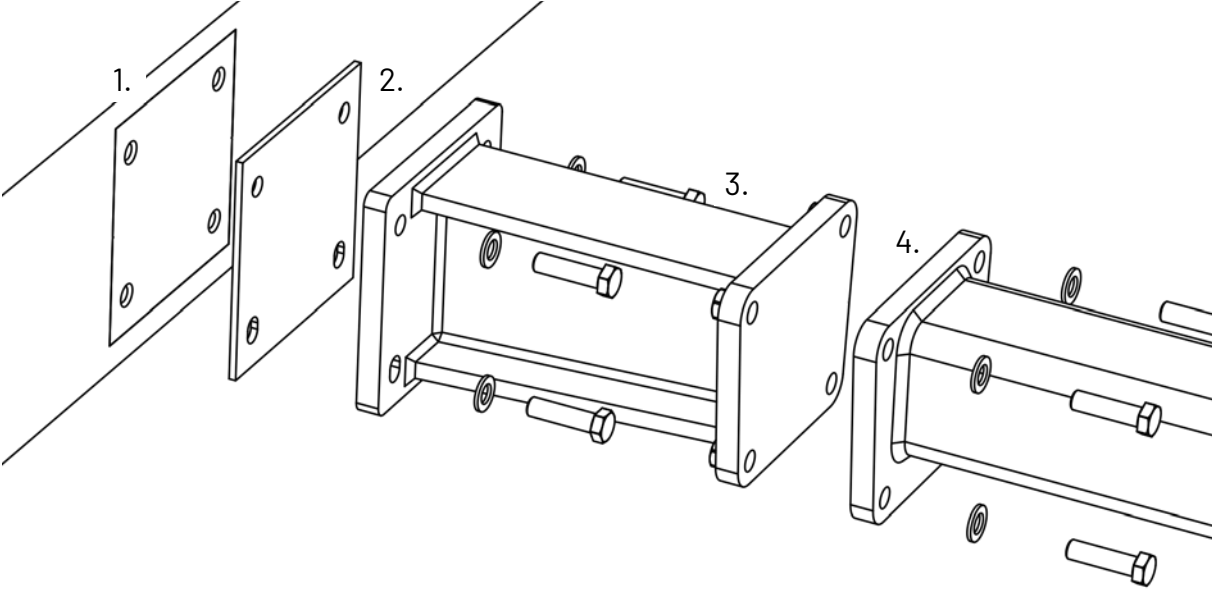

4

- 1. Cast In Anchor – subject to structural calculations
- 2. Thermal break pad
- 3. Stub-connector
- 4. Cantilever arm

Project specific Stub-connector

Levitate balcony positioning is dictated primarily by the angle and length of the Stub-connector. Stub connector cross-section subject to structural calculations, and also angles nearing 45°.

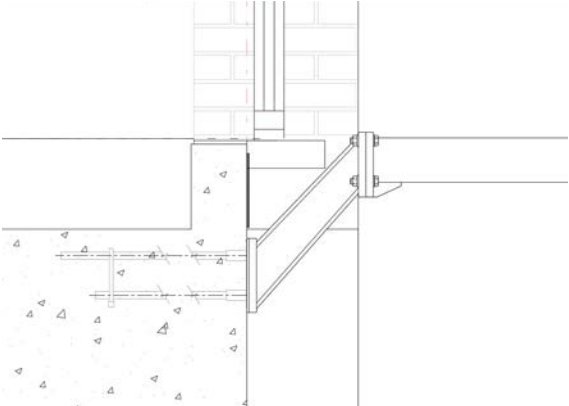

Stub-connector max inclination 45°

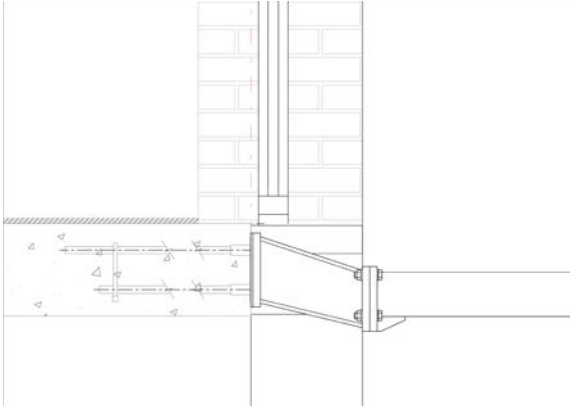

Stub-connector max declination 15°

Cantilever arm

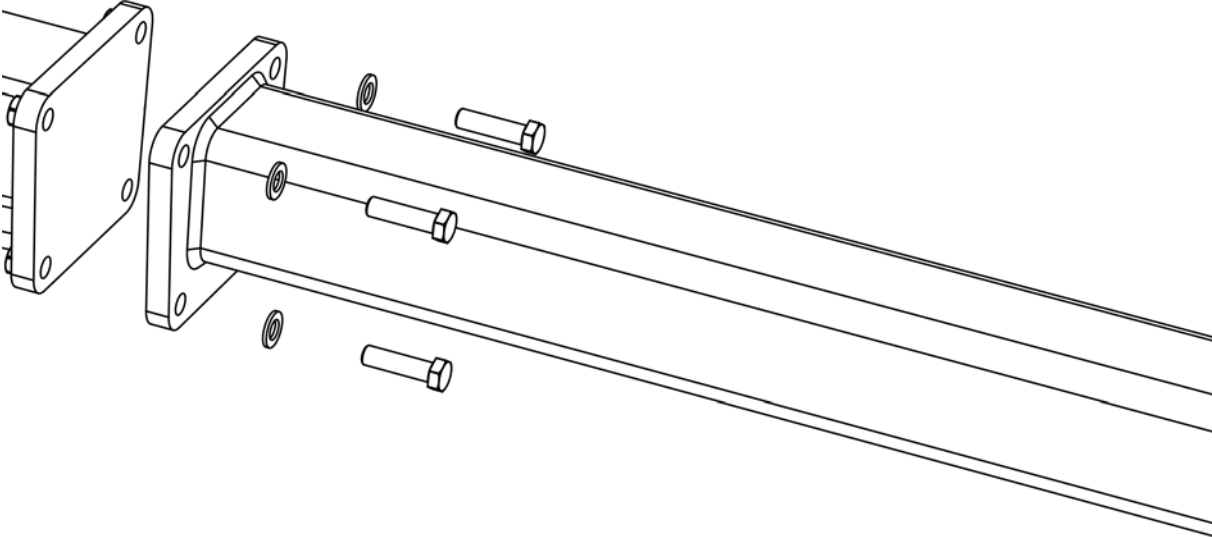

Max 5mm deflection at 2kN point load incorporated in structural calculations.

*Eigenfrequency minimum 5Hz.

Patent pending: Anti-slag slide on technique.



Slab elements

1. BS8579 compliant concrete tile flooring or Aluminium decking according to BS7976-2+A1:2013
2. Secondary support cassette EN-AW 6063 T66
3. Steel frame S355
4. Soffit EN-AW 1050

Levitate complies with material class A1 or A2-s1,d0 according BS EN 13501-1:2018.

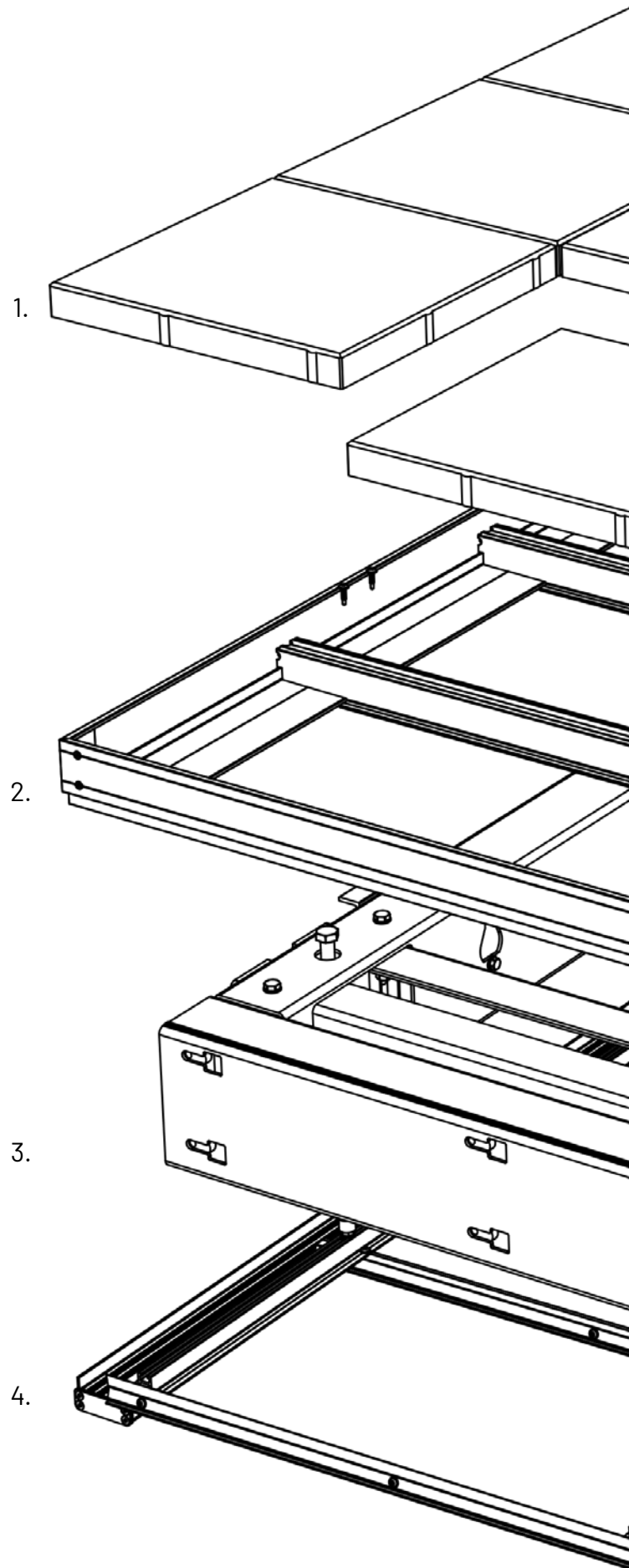

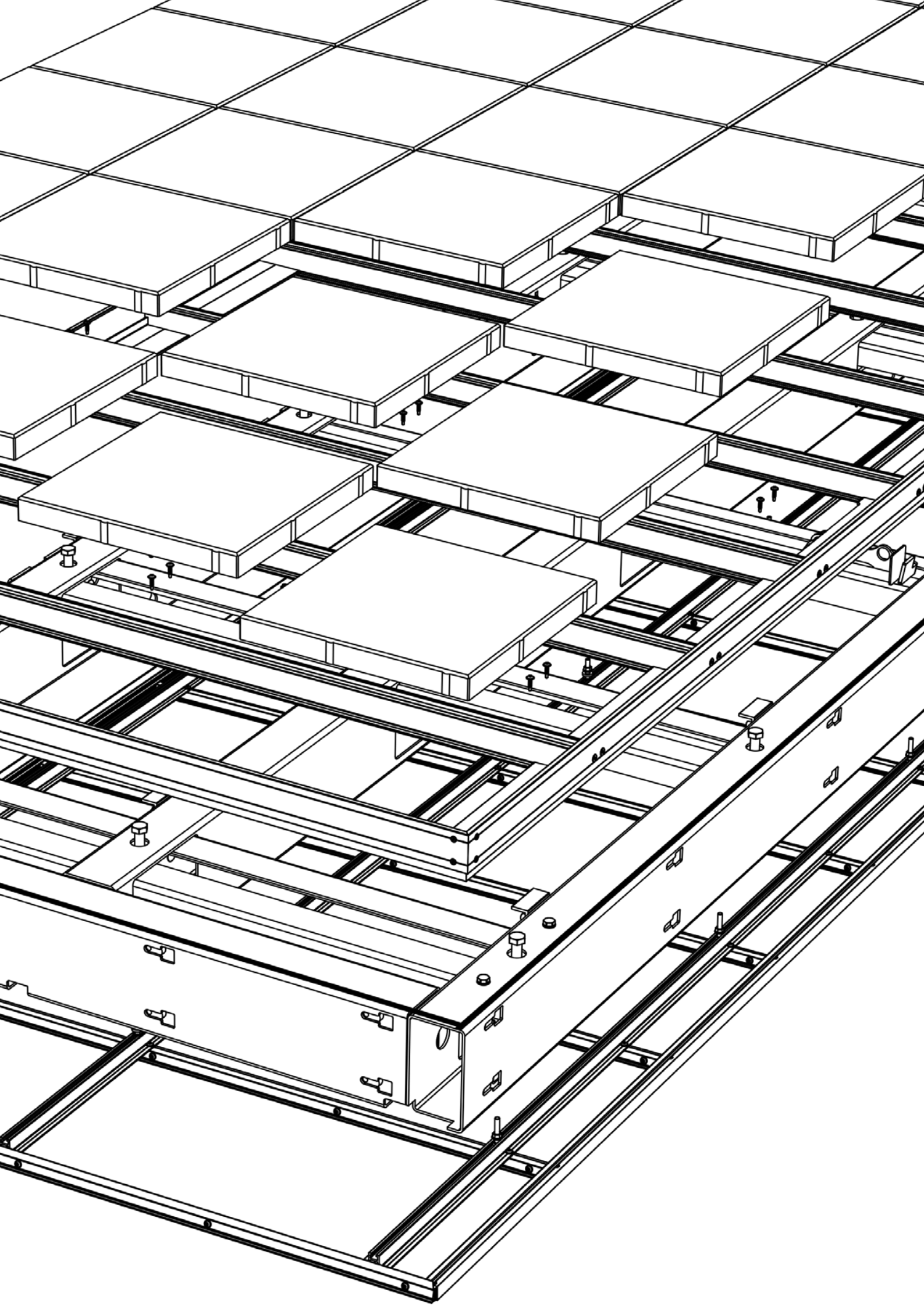

Frame structure with clamp system

Clamp system

Clamps verified by Balco test facility.
Apertures allow for 20 mm tolerance.

Safety latch – provides a self-locking function
which enables fitters safe access to the balcony.

Height adjustment points

Lifting points
for certified equipment

Balustrade connection points

8

Balustrade connection point, Bobin,
with Balco's patented threaded insert.

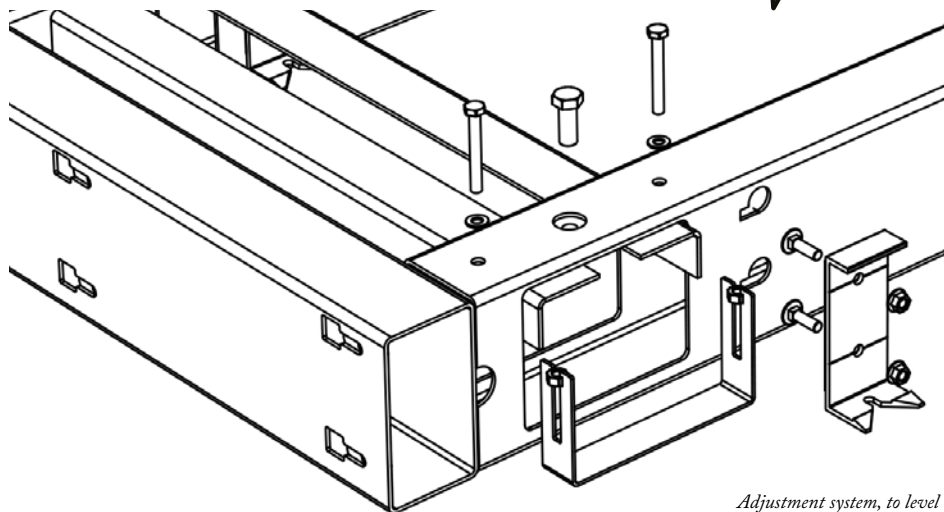
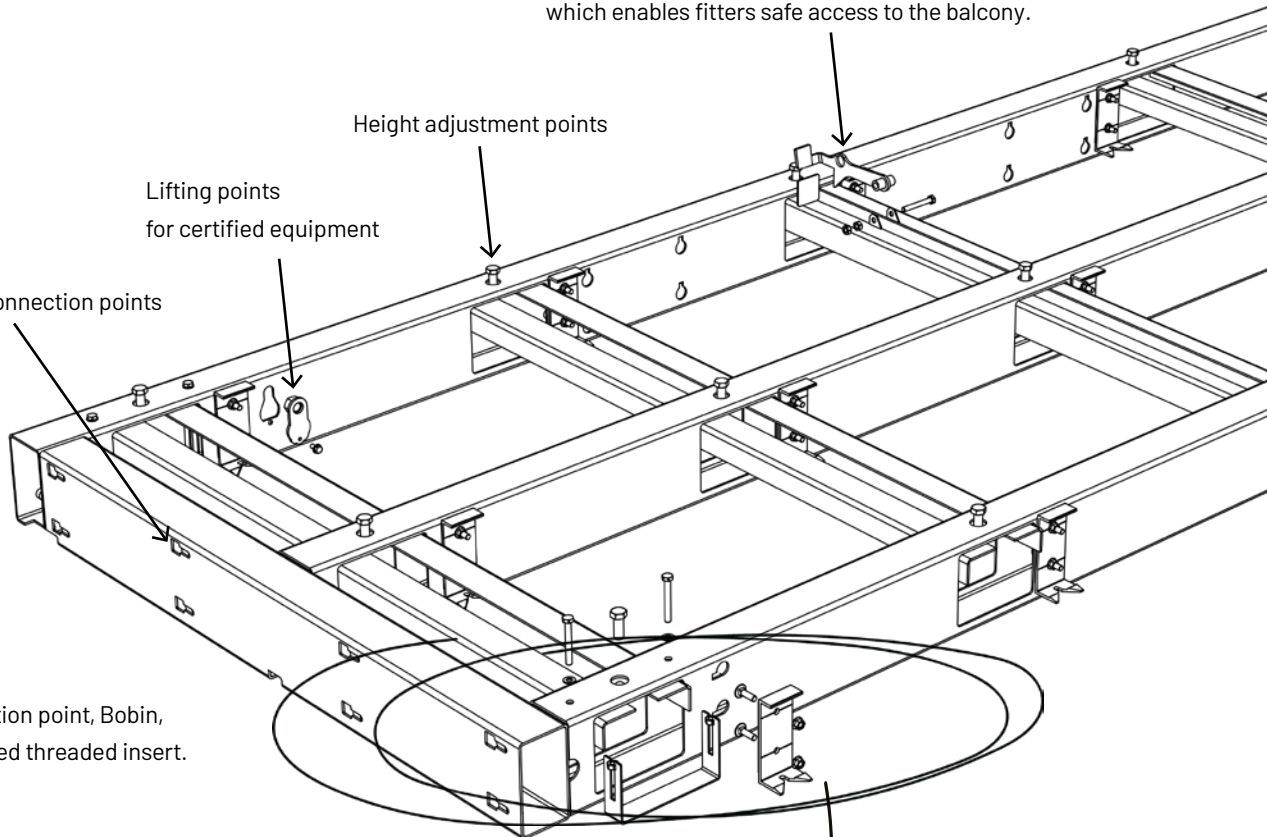

*Adjustment system, to level out frame or
adjust slab height.*

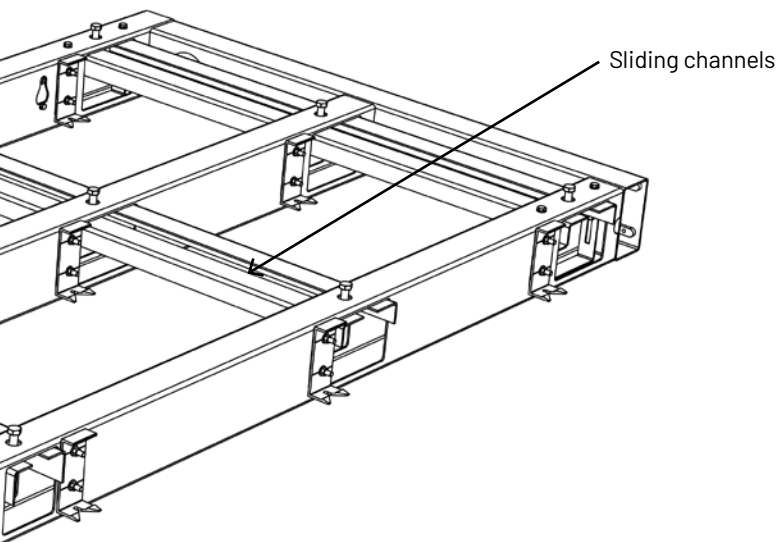

Frame structure view of clamp mechanism

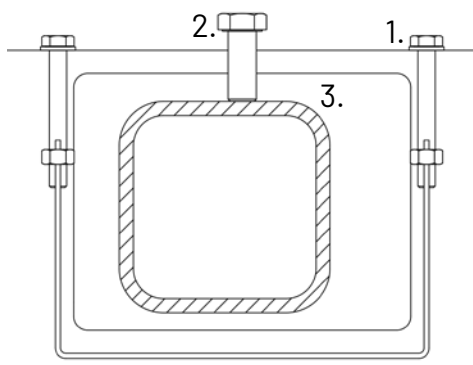

Pre lock example

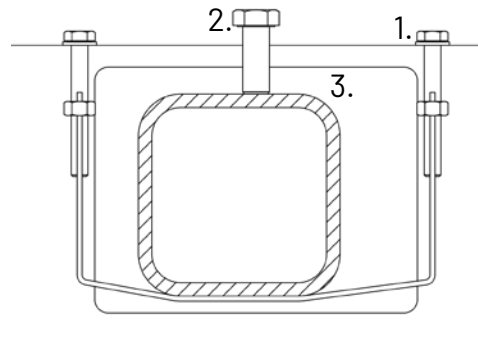

Post lock example

Clamp mechanism

Bolts in accordance with DIN933 and ISO4017.

Each clamp is able to resist pull forces of 3.43kN.

Patented, and tested at Balco's lab.

1. Clamp
2. Height adjustment points
3. Sliding channel

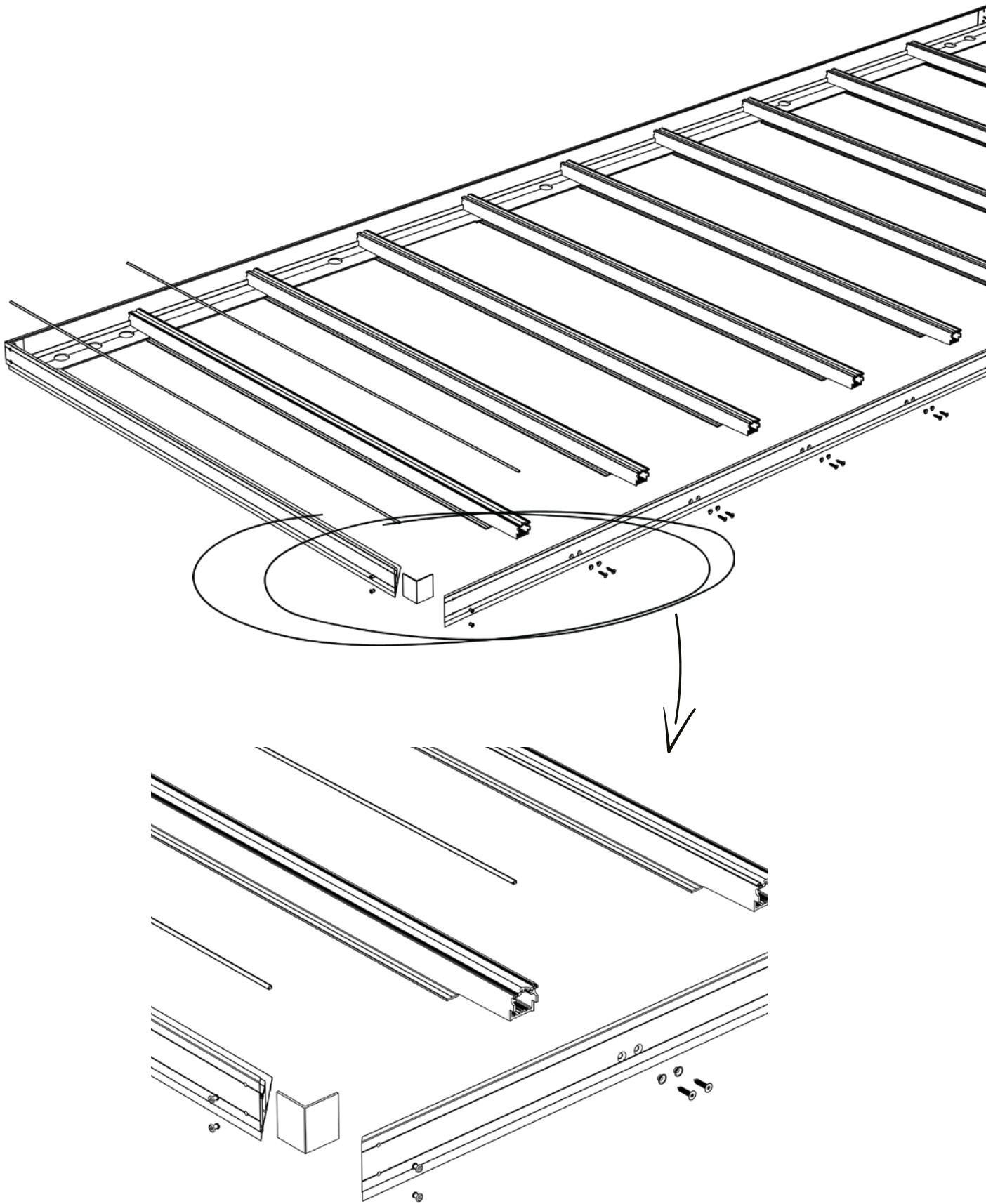

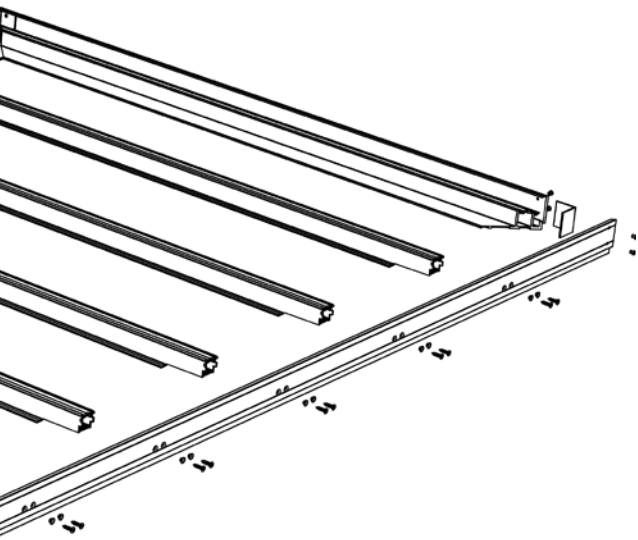

Secondary support cassette

Aluminium alloy: EN-AW 6063-T66 Material classification according EN13501-1:2018 as A1.
Rubber gaskets in accordance with exemptions in Regulation 7(3) to adapt to all decking options.

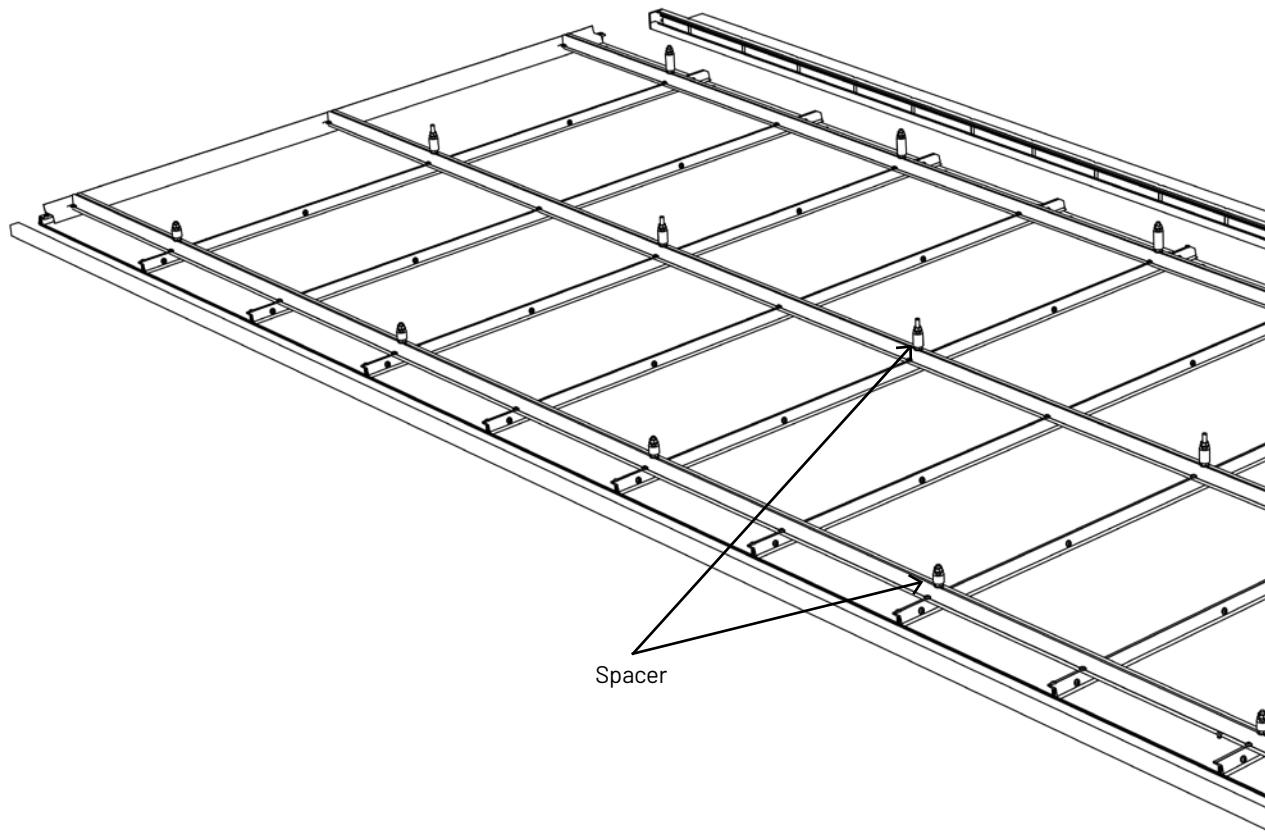

Soffit cassette with edge drainage

BS8579: Balconies should not have a perforated pedestrian surface draining directly onto balconies and public spaces below without a water collecting surface.

Levitate is fitted with a soffit which manages rainwater through either 'edge' or 'piped' drainage systems.

Levitate soffit is always set to a fall of at least 1:80

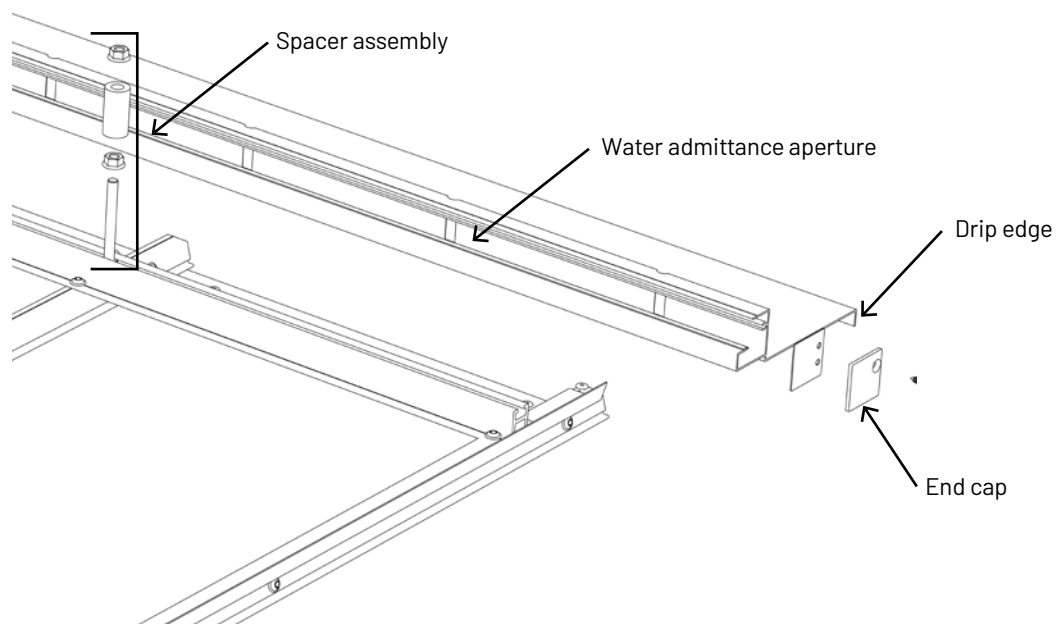
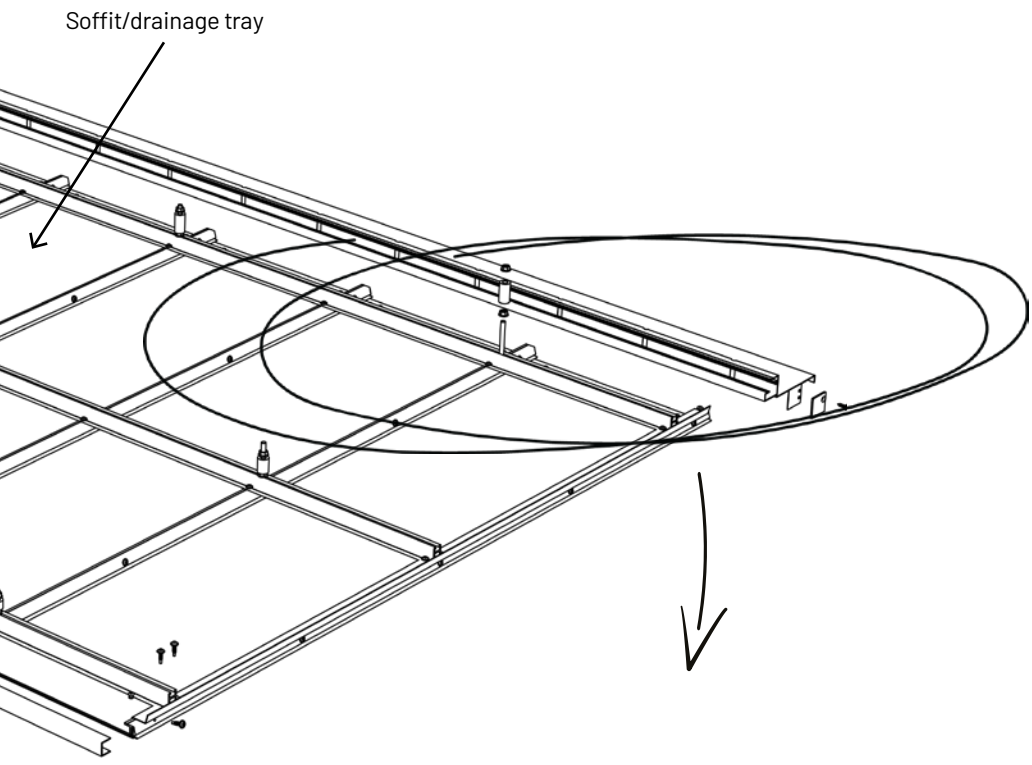

Adjustable drainage holes to allow for compliance with drainage when against adjacent walls

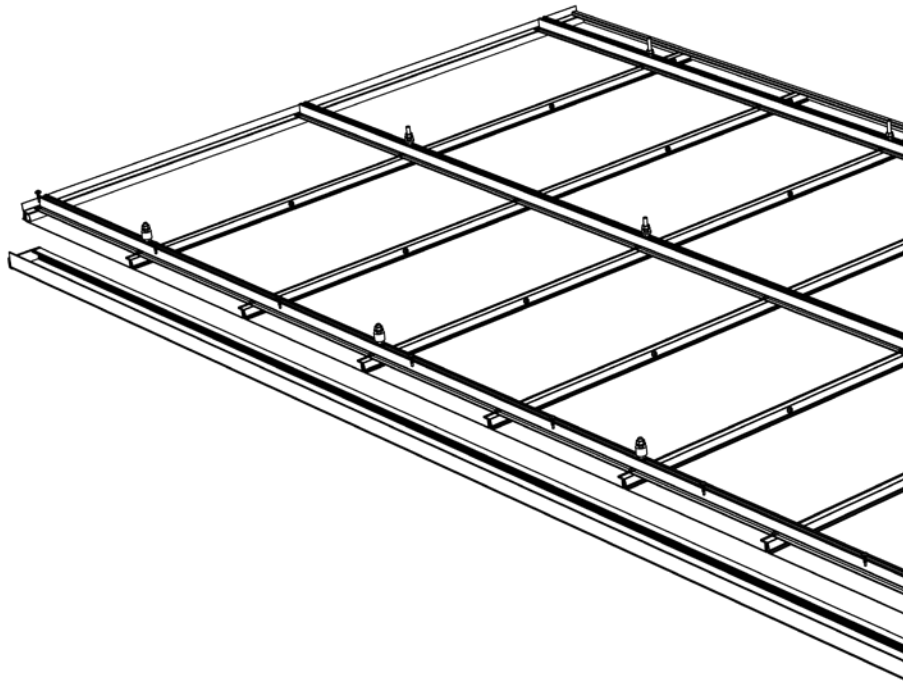

Soffit cassette with piped drainage

BS 8579: Where the soffit acts as the principle water collecting surface, it should be set to fall so that it is self-cleansing.

Levitare soffit is always set to a fall of at least 1:80

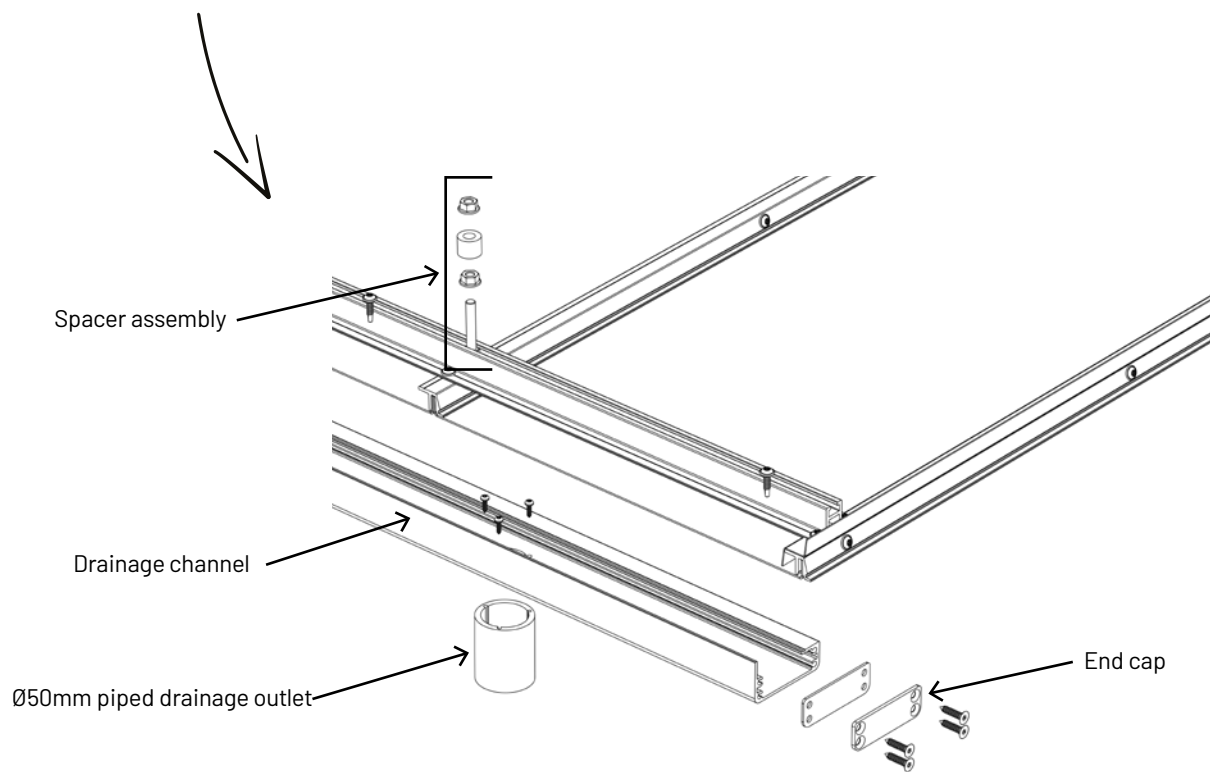
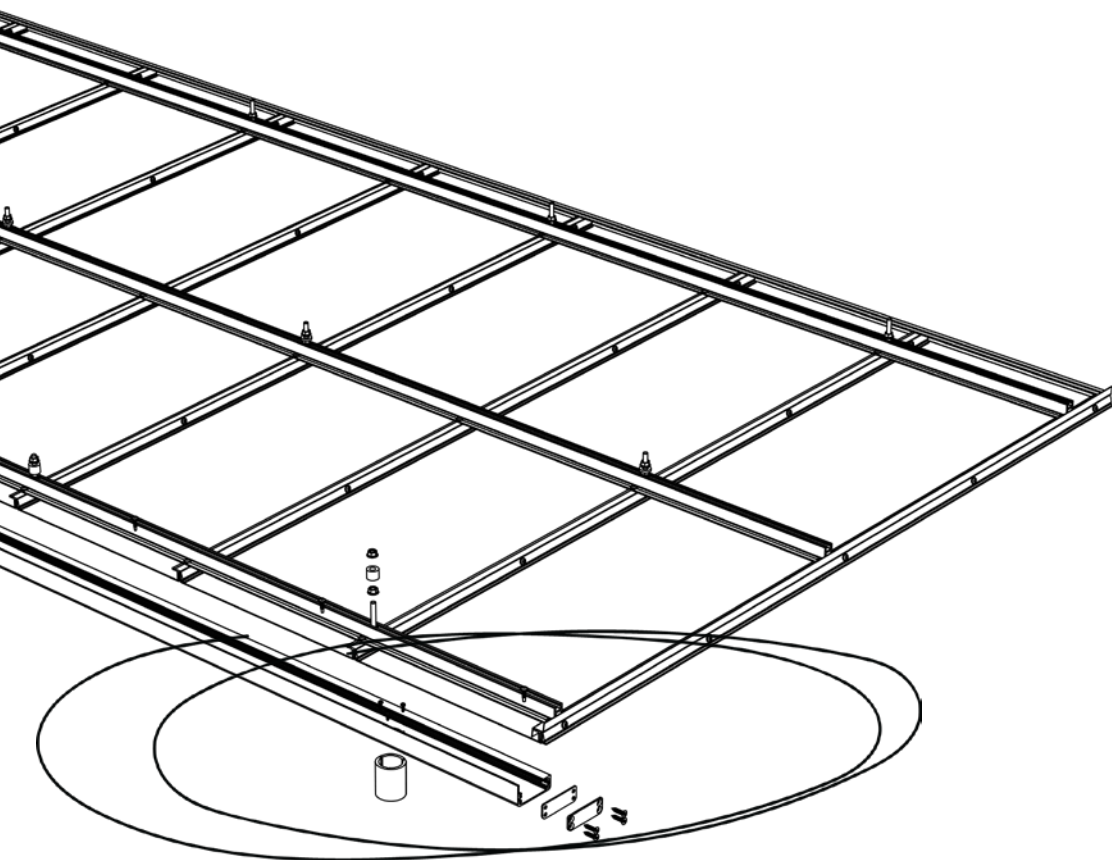

BS8579:2020 Compliance analysis

Chapter Scope	Requirement None	Solution or feature on Levitate®	Chapter Scope	Requirement None	Solution or feature on Levitate®	
Normative references	Referred standards:	X = Used in structural calculations	Sight lines via balconies and terraces	Circular holes ≤ 10mm.	No circular holes in any decking type.	
	BS 6180, Barriers in and about buildings – Code of practice.	X		Balcony should not screen off intended view.	Different balustrade designs are available.	
	BS EN 1990, Eurocode – Basis of structural design.	X		50% view through balustrade.	As above	
	BS EN 1991 (all parts), Eurocode 1 – Actions on structures.	X		Structural and mechanical stability and integrity	Thermal break to reduce heat loss and avoid condensation.	Thermal break pads or thermal break connectors are used.
	BS EN 1992 (all parts), Eurocode 2 – Design of concrete structures.	X			Suitability in terms of tolerances, camber etc.	Accounted for in Levitate balcony design phase.
	BS EN 1993 (all parts), Eurocode 3 – Design of steel structures.	X			Accounting for low rotational spring in thermal break connectors.	Incorporated in Levitate structural calculations.
	BS EN 1994 (all parts), Eurocode 4 – Design of composite steel and concrete structures.	X			Design should be according BS standards:	All Levitate and balustrade structural calculations are performed according listed standards, including UK National annexes and NCCs where available. Glass design in balustrade is confirmed by testing.
	BS EN 1999 (all parts), Eurocode 9 – Design of aluminium structures.	X			• BS 6180, Barriers in and about buildings – Code of practice.	
	BS EN 1090 (all parts), Execution of steel and aluminium structures.	X			• BS EN 1990, Eurocode – Basis of structural design.	
	NA to BS EN 1990, UK National Annex for Eurocode – Basis of structural design.	X			• BS EN 1991 (all parts), Eurocode 1 – Actions on structures.	
	NA to BS EN 1991 (all parts), UK National Annex to Eurocode 1.	X			• BS EN 1992 (all parts), Eurocode 2 – Design of concrete structures.	
	NA to BS EN 1992 (all parts), UK National Annex to Eurocode 2.	X			• BS EN 1993 (all parts), Eurocode 3 – Design of steel structures.	
	NA to BS EN 1993 (all parts), UK National Annex to Eurocode 3.	X			• BS EN 1994 (all parts), Eurocode 4 – Design of composite steel and concrete structures.	
	NA to BS EN 1999 (all parts), UK National Annex to Eurocode 9.	X			• BS EN 1995 (all parts), Eurocode 5 – Design of timber structures.	
	PD 6689-1-4, Background information to the National Annex to BS EN 1991-1-4 and additional guidance.	X			• BS EN 1999 (all parts), Eurocode 9 – Design of aluminium structures.	
		• BS EN 1090 (all parts), Execution of steel and aluminium structures.				
		• BS EN 16612, Glass in building – Determination of the lateral load resistance of glass panes by calculation.				
		• iStructE, Structural use of glass in buildings [N1].				
General principles	Balconies, terraces and access decks should be designed to provide amenity and sized for intended use. Levitate is intended for use with single dwellings. Design should aim for quality and functionality.	Levitate is available in standard sizes with tile patterns of 3x6 up to 5x12. Aludecking is available in sizes in between as well. Levitate is CE and UKCA marked.	Both Ultimate and Serviceability combinations need to be considered. Movements and deflections restricted. Deflection max 5mm at 2kN static load. Vertical Eigen frequency minimum 5Hz.	Incorporated in structural calculations.	Incorporated in structural calculations.	
Wind effects	Design of balconies, guarding and weather screens should mitigate nuisance effects from wind. Consideration should be given to tie-down points.	Different balustrade designs available, also including wind screens. Levitate is secured by steel clamps and safety latch.				
Wind mitigation measures	Increased wind loading from any higher balustrade/screen. Net wind pressure factors.	Object specific structural design in case of high screens. Wind pressure coefficients according eurocode are incorporated in Levitate and balustrade structural calculations. Not according Figure 5.				
Service life	Service life equal to buildings primary structure. Pedestrian surface and balustrade infill 30 years. Components disproportionately difficult or impracticable to inspect or repair should have service life as designated primary components. All other balcony components should be designated as secondary components and should be easy to inspect. Safe method to replace secondary components should be demonstrated in the design. Assessment of water ingress to interlayer in laminated glass. Capping should be made to susceptible interlayers. Base channels should include drainage. Balco can offer a bespoke Maintenance agreement for each project if required.	Design life of Levitate balcony main structural components 60 years. For Levitate: Concrete tiles according EN1339:2003 or painted aluminium decking. Balustrade infills durability similar to balcony main structure. Design life of Levitate balcony main structural components 60 years. Secondary components are easily inspected, as it is possible to disassemble the product into modules. Secondary components are easily replaced, as these belong to subassemblies of the final product. Considered in balustrade design. Considered in balustrade design. Balcony levelled to 10mm below indoor FFL.	Safety Persons occupying the balcony or terrace	Aspects for safety: a) Loading of structure - Walking surface should not be dislodging by wind, flotation or humans b) Loading of envelope/guarding c) Prevention of falls. Prevent both people and objects. Non-climbable, also between balconies. Terraces, balconies and Juliet guardings 100mm high above pedestrian surface or FFL. Toe hold <25mm. Risk assessment or design incorporating a toe hold should trigger height to 100mm above step. Toe hold 300-600mm require increased guarding heights. Protection from wind. Mitigate risk for vertigo. d) Slip prevention. - Rz > 20µm - BS7976 - Max 3mm steps on pedestrian surface. e) Safety for persons below. - Prevention of falling objects. - Handrail top surface non-level. - Brittle materials prevented from falling down. - Prevent liquids	These aspects are handled by: a) Structural calculations - Heavy tiles, Aludecking screwed to frame b) Structural calculations c) Balustrade Balustrade according BS6180 Balustrade according BS6180. Screens at adjoining balconies. Safety height 100mm in balustrade design. Steel balustrade have a thin side cover plate / flashing. Narrow aluminium profiles in balustrades. 100mm is always safety height in balustrade design. - Increase height to 700mm above toe hold (at least 1100mm above pedestrian surface). - Architects responsibility (Different balustrade designs are available). - Higher balustrade available. Handrail provided on balustrade. Concrete tiles provide slip resistant surface. - Profiled aludecking. Concrete surface. - Aludecking paint with properties certified according BS7976-2+A1:2013. - Even thicknesses on tiles and decking profiles respectively. Following BS6180 for balustrades. - Toe board included in balcony side cover plates. - Either slanted 15degrees or rounded handrails available - Concrete tiles always on top of metal sheet soffit. - Drainage through soffit	
Inclusive design	Balconies should be designed to provide equal utility and enjoyments for all users. Threshold should be designed to minimum restriction or trip hazard. The threshold of this door should be level from indoor FFL to balcony FFL. Transition surfaces should fulfill: a) Internal transition max slope 15°, max length 150mm. b) Threshold upstand <15mm and trough minimized.	Threshold maximum 4mm above general balcony FFL. Bespoke stub connectors for levelling of the balcony pedestrian surface. Bespoke stub connectors for levelling of the balcony pedestrian surface.				
Thresholds						
Balcony and terrace surfaces	If drain-type pedestrian surface, finishes should make sure risk for entrapment is removed. Slots max 8mm wide due risk of entrapment.	See below. Nominal gap of 1mm between concrete tiles. Aludecking nominal gap 6mm.				

Chapter	Requirement	Solution or feature on Levitate®	Chapter	Requirement	Solution or feature on Levitate®
Safety	<p>Aspects for safety</p> <ul style="list-style-type: none"> Prevent dislodging <p>f) Safety for service.</p> <ul style="list-style-type: none"> Avoid work under suspended load and work at height. Cleaning of guarding inside. Access to inspect support structure, drainage and paint. Cleaning with rope access. Rope access connection points. Abseil connection points. 	<p>These aspects are handled by:</p> <ul style="list-style-type: none"> Screwed connections to balcony frame. Levitare features a locking device which enables secure work. O&M Possible to lift tiles/unscrew profiles Not allowed according current design. Not featured in Levitate Not featured in Levitate 	Safety	<p>Aspects for safety</p> <p>Large terraces</p> <p>Require piped drainage and BS8229 should be followed.</p>	<p>These aspects are handled by:</p> <p>Not applicable to single Levitate. Large, coupled balconies can be equipped with piped drainage.</p>
			Prevention of water ingress into the building.	<p>a) Water collecting surface 75mm below ingress level.</p> <p>b) Spillover at least 25mm below ingress level.</p> <p>c) Water collecting surface nominal 25±10mm below spillover level.</p> <p>The client can if they wish apply mastic around the stub connector where it protrudes through the building façade to assist in stopping any water ingress.</p>	<p>Levitare's soffit is placed at the underside.</p> <p>Spillover (free edge drain) close to soffit level.</p> <p>Spillover 20mm above soffit's water collecting surface.</p>
Performance in fire – General	<p>No additional risk to building or adjacent building.</p> <p>Components exposed to fire should:</p> <p>a) Not provide a medium for fire spread due to material or design.</p> <p>b) Not propagate fire downwards through falling objects.</p> <p>c) Be designed to remain in place (no risk for firefighters or the public)</p> <p>d) Designed to not affect buildings stability when large deformations occur</p> <p>Open balconies not for access paths do not require fireproof design if size is small enough.</p> <p>Access balconies and escape routes classed as floor which require fire resistance from underside.</p>	<p>Non-combustible materials</p> <p>Non-combustible materials</p> <p>Non-combustible materials</p> <p>Load-bearing structure designed for R30 according external fire curve. Locking mechanism featured.</p> <p>Levitare have no vertical connections, hence no destabilizing loads other than regular ULS and SLS. Large deflections do not cause any problem, since there are a lot of space below balconies.</p> <p>Levitare is for single dwelling units only.</p> <p>Levitare is not intended as access balcony.</p>	Managing water drainage.	<p>Blocked outlet require an overflow to prevent water from entering the building.</p> <p>Warning pipe should be provided where flow from overflow is hidden.</p> <p>When water collecting surface does not coincide with deck level, design should enable inspection and maintenance.</p> <p>Soffits should be ventilated.</p> <p>Soffit should be set to falls when used as water collecting surface.</p>	<p>Overflow at edge drainage of soffit.</p> <p>Overflow is visible.</p> <p>Both tiles and aludecking is possible to dismantle.</p> <p>Levitare soffit is ventilated.</p> <p>Levitare soffit is always set to falls (1:60).</p>
Materials and components for balconies in respect to fire.	<p>Components of balconies with floor level 11m above ground should be of material class A1 or A2-s1,d0 according BS EN 13501-1:2018. This applies also to all stacked balconies.</p> <p>All other buildings should have risk assessed to prove adequate resistance. Minor components exempt from requirement according national regulations.</p> <p>Guardings to access balconies imperforate.</p> <p>Open structures and open pedestrian surface should be fitted with imperforate tray to reduce risk of fire spread.</p> <p>Drainage pipe through soffit to be evaluated on risk for fire spreading.</p>	<p>Levitare act as Single units (not stacked). Steel and Aluminium classified as A1 materials.</p> <p>Levitare is non-combustible. If customer requires solution with other materials a risk assessment may be performed.</p> <p>Different solutions available e.g. aluminium sheet.</p> <p>Drainage soffit serve as fire protection.</p> <p>Non-combustible materials used, except sealant but volume used is negligible.</p>	Edge drainage of balconies and small terraces.	<p>a) Falls at least 1:80, for on-site built balconies, 1:60 to 1:40 is recommended.</p> <p>b) Water collecting surface projection 30mm beyond vertical surface.</p> <p>c) Drain via edge furthest from the wall. At adjacent walls, no discharge within 400mm from wall.</p> <p>d) Flow concentrations should be avoided.</p> <p>e) Edge drain allowed if plan depth collecting surface never more than 2500mm.</p> <p>g) Collecting surface allows drainage from window sills but not roofs or other balconies.</p> <p>NOTE 1: balconies below 6m² may omit gutter and rainwater pipes. e) gives a limit for drain length /area for an even outflow.</p> <p>NOTE 2: Gutters and rainwater pipes may be omitted from tall structures. Such runoff should be directed.</p>	<p>1:60 is used on the soffit.</p> <p>Drainage of soffit through and edge drain profile, extending more than 30mm from balustrade front plane.</p> <p>Exit slots in edge drain profile are avoided within 400mm from the wall.</p> <p>Exit slots evenly distributed over the length of the edge profile.</p> <p>Max depth is 5 tiles (ca 2000mm)</p> <p>Window sills are allowed to drain on Levitate.</p> <p>Levitare always fulfill limit in e), but also have the possibility to divide large balconies into more slabs.</p> <p>It is possible to direct the runoff by soffit and edge profile configurations.</p>
Weathering and hydraulic design. General	<p>Design should take the following into account:</p> <ul style="list-style-type: none"> Rainwater outlet design Overflow design 	<ul style="list-style-type: none"> Levitare options: Piped drainage or Edge drainage. Free edge overflow 	Pipe and outlet design	<p>Vertically stacked pipes should fully extend down to the receiving outlet.</p> <p>Outlets accessible and incorporate removable grating.</p> <p>Outlets should be slightly recessed to avoid ponding.</p>	<p>Possible to accomplish with Levitate.</p> <p>Tiles and aludecking removable.</p> <p>Outlet is fitted to a drainage profile.</p>
Drainage of balconies and small terraces.	<p>Controlled drainage should be used to prevent water ingress and staining of the building and/or nuisance to people or landscaping below.</p> <p>Pedestrian surface should not have free standing water or give rise to water ingress of the building via accessible threshold.</p> <p>As-built gaps between planks/slabs should be between 6-8mm to achieve effective drainage and minimize discomfort to wheelchair users.</p> <p>Gaps of 10-12mm around perimeter.</p> <p>Balconies should not drain through perforations directly on balconies or public spaces below without a water collecting surface.</p> <p>For balconies with upstands on all sides, water collecting surface can be designed falls or flat with no back falls or ponding.</p> <p>The design of support structure for water collecting surface should include tolerances and deflections to ensure falls.</p> <p>If collecting surface is flat, then screed, layer, filler should be used to ensure no ponding occurs. Structural analysis should be used to estimate movements in order to verify drainage.</p> <p>Balconies and terraces guide for tiles in BSS385-3.</p>	<p>Levitare have two options: Piped drainage and Edge drainage.</p> <p>Levitare have decking options with concrete tiles and aluminium flooring, both with porosities for drainage. Thresholds (balcony extensions against facade) can have the same flooring as slab, with drainage connected to slab drainage.</p> <p>Nominal distance between tiles: 3mm (as casted).</p> <p>Nominal distance at perimeter: 2mm.</p> <p>Levitare is fitted with a soffit which handle the drained water.</p> <p>Levitare is designed with porous pedestrian surface with a sloping soffit (1:60) that directs the water.</p> <p>Fixed slope of the soffit ensures the fall and eliminate ponding.</p> <p>Soffit is always sloping. Deflections are included in structural calculation pack.</p> <p>BSS385-3 is for tiles in grouting, not applicable to Levitate.</p>			

Technical summary

18

- CE/UKCA marked according EN1090, EXC2.
- 60 year design life.
- Structural calculations for ultimate resistance as well as deflections at serviceability limit state.
- Max 5mm deflection at 2kN point load incorporated in structural calculations.
- Eigenfrequency minimum 5Hz.
- BS8579 compliant.
- Compliant with Approved Document B: Regulation 7.
- BS EN 1990, Eurocode – Basis of structural design.
- BS EN 1991 (all parts), Eurocode 1 – Actions on structures.
- BS EN 1992 (all parts), Eurocode 2 – Design of concrete structures.
- BS EN 1993 (all parts), Eurocode 3 – Design of steel structures.
- BS EN 1999 (all parts), Eurocode 9 – Design of aluminium structures.
- BS EN 1090 (all parts), Execution of steel and aluminium structures.

Levitate and balustrade structural calculations are performed according relevant BS standards, including national annexes and NCCI's, such as:

- BS 8579:2020, Guide to the design of balconies and terraces.
- BS 6180, Barriers in and about buildings – Code of practice.

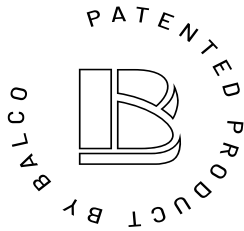

Balco owns over 40 patents which make our products unique within our industry.



Every year the global agency Dun & Bradstreet performs a credit assessment of multiple companies. Over the last ten years we have achieved the highest credit rating – AAA.



ISO 9001 and ISO 14001 Certification means that we work in accordance with a certified business management system. Balco has been certified within these two standards since 1999 and sees these systems as major factors in our growth over the years.



SMAS Worksafe is one of the UK's leading providers of health and safety assessments and a national leader in providing full form SSIP (Safety Schemes in Procurement).



CHAS is the UK's leading provider of compliance and risk management solutions. A co-founder of Safety Schemes in Procurement (SSIP) and the Common Assessment Standard



Constructionline has been working with construction buyers and suppliers for over 20 years to develop a deep understanding of buyers' needs. Constructionline prides itself on opening up opportunities for members to access a wide range of procurement contracts and projects – and for buyers to access a validated pool of high quality suppliers.

www.balcouk.com

Balco Balcony Systems Ltd

The Wagon House, Prockters Farm
West Monkton, Taunton TA2 8QN, United Kingdom

balco@balcouk.com



BALCONIES
FOR
GREATER
LIVING